

ALL DIMENSIONS ARE IN mm IF UNLESS STATED

DO NOT SCALE, IF IN DOUBT PLEASE ASK

SECTION VIEW:AA

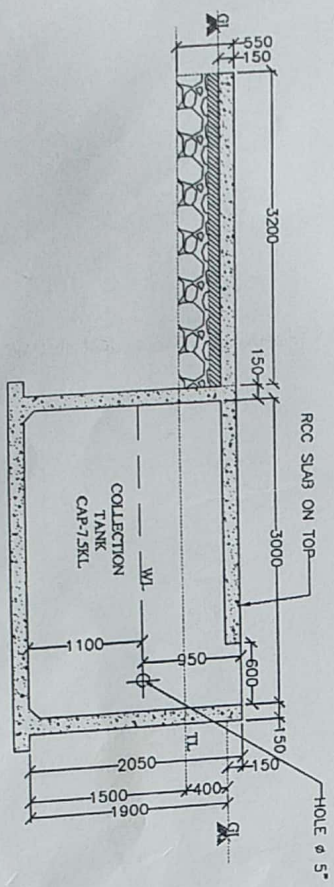

PLAN VIEW

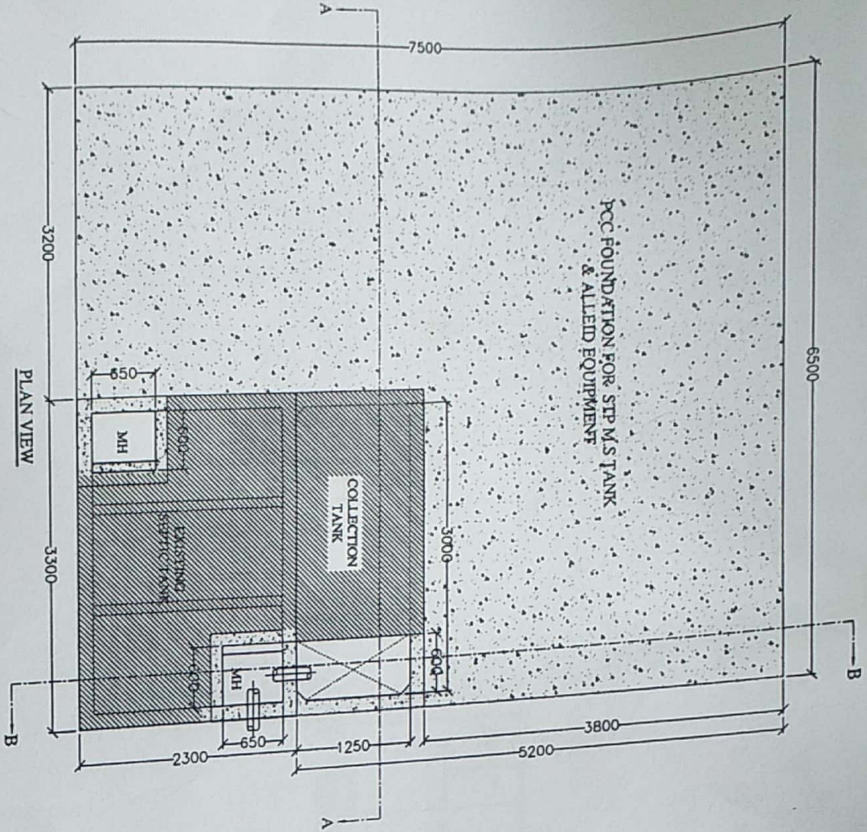

SECTION VIEW:BB

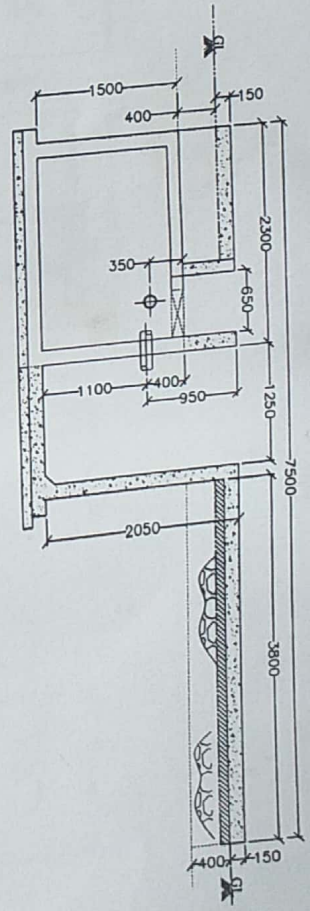

NOTE:  
 1) NEW COLLECTION TANK OVER ALL SIZE: L-3000 X W-1250 X 3050 HT. CON VOL- 7.8KL  
 2) RCC FOUNDATION FOR STP M.S TANK WITH ALLED EQUIPMENT APPROX. LOAD-40.0TON

*Final Drawing*

THIS DRAWING IS THE PROPERTY OF SAM CONSULTTECH, AMBAD, NASHIK. IT SHOULD NOT BE USED COPIED, REPRODUCED OR EXHIBITED IN ANY DETERIMENTAL TO OUR INTEREST WITHOUT OUR WRITTEN CONSENT

**SAM ENVIRO**  
 PLOT No. F-20, MIDC, AMBAD, NASHIK -  
 CALL : (+91-0253) 2385551, WEB : www.samcc

CLIENT : METAFORGE ENGINEERI

TITLE : CIVIL TANK FOUNDATION DWG

DATE : 20/07/2018  
 MATERIAL : RCC  
 SCALE : 1:1  
 DRG. NO. : SAM-MEHTA-02

DESIGNER	CHKD	APPD	REV
DGN DD	SS	S	

HYDRAULIC FLOW DIAGRAM

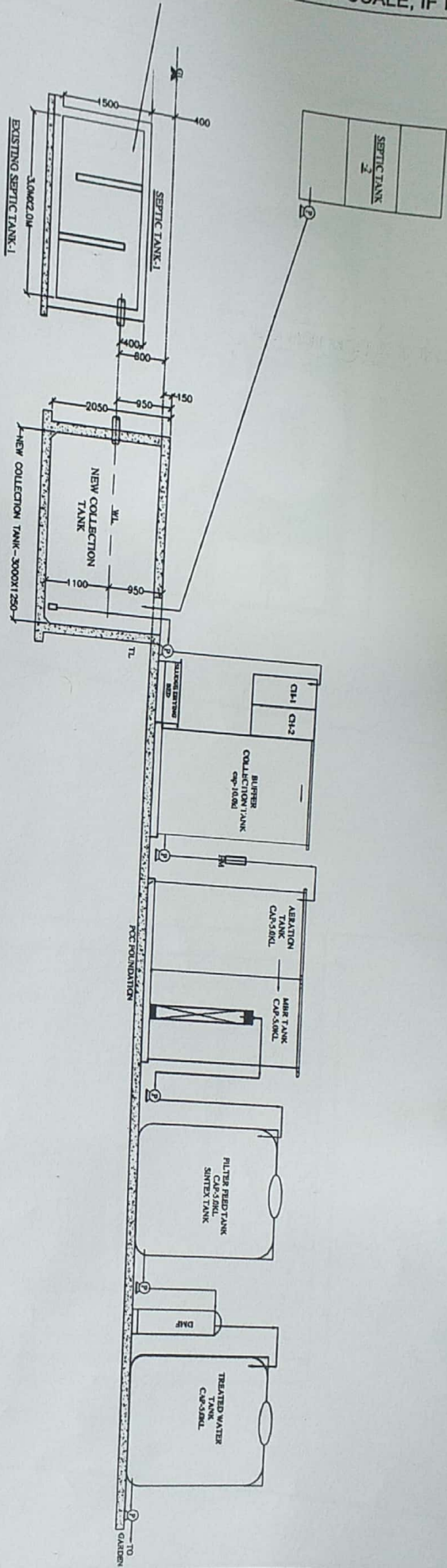

STP TANK DETAIL

SR NO	NAME OF TANK	SIZE / CAP-	MOC
1)	EXISTING SEPTIC TANK	10.0KL	RCC
2)	COLLECTION TANK	4.1 KL	RCC
3)	BAR SCREEN & OIL GREASE CH.	0.6 KL	M.S.FRP
4)	BUFFER (COLLECTION TANK)	10.0KL	M.S.FRP
5)	AERATION TANK	5.0 KL	M.S.FRP
6)	MBR TANK	5.0 KL	M.S.FRP
7)	FILTER FEED TANK	5.0 KL	HDP/SINTEX
8)	TREATED WATER TANK	5.0 KL	HDP/SINTEX
9)	SLUDGE DRYING BED	1.0 KL	PP

THIS DRAWING IS THE PROPERTY OF SAM CONSULTTECH, AMBAD, NASHIK. IT SHOULD NOT BE USED COPIED, REPRODUCED OR EXHIBITED IN ANY DETERMENTAL TO OUR INTEREST WITHOUT OUR WRITTEN CONSENT



**SAM ENVIRO**

PLOT No. F-20, MIDC, AMBAD, NASHIK - 422010  
CALL : (+91-4253) 2383551, WEB : www.samconepd.com

CLIENT : METAFORGE ENGINEERING

TITLE : HYDRAULIC FLOW DIAGRAM

PANU L. B. DATTU-20/METRA VING-04	SCALE 1:1	DRN DDS 23.11.20
MATERIAL : RCC		DGN SSP 23.11.20
DRG. NO. : SAM-METRA-04		CHD SSM 23.11.20
		APPD SAM 23.11.20
		REVISION : 01

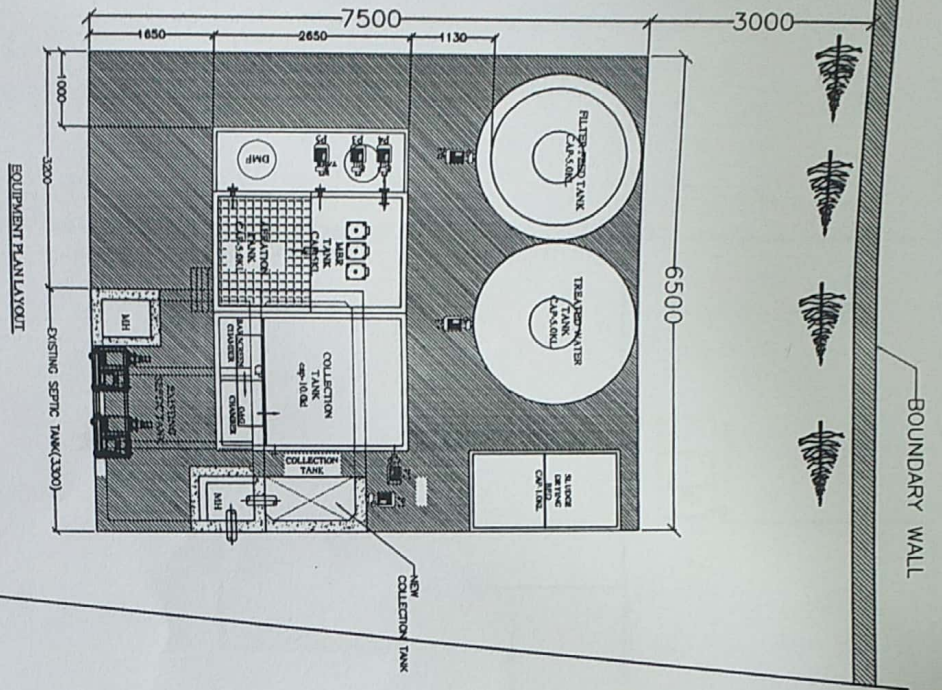

NOTE:  
 1) RCC FOUNDATION DESIGNED TO BE APPROX-40.0 TON LOAD.

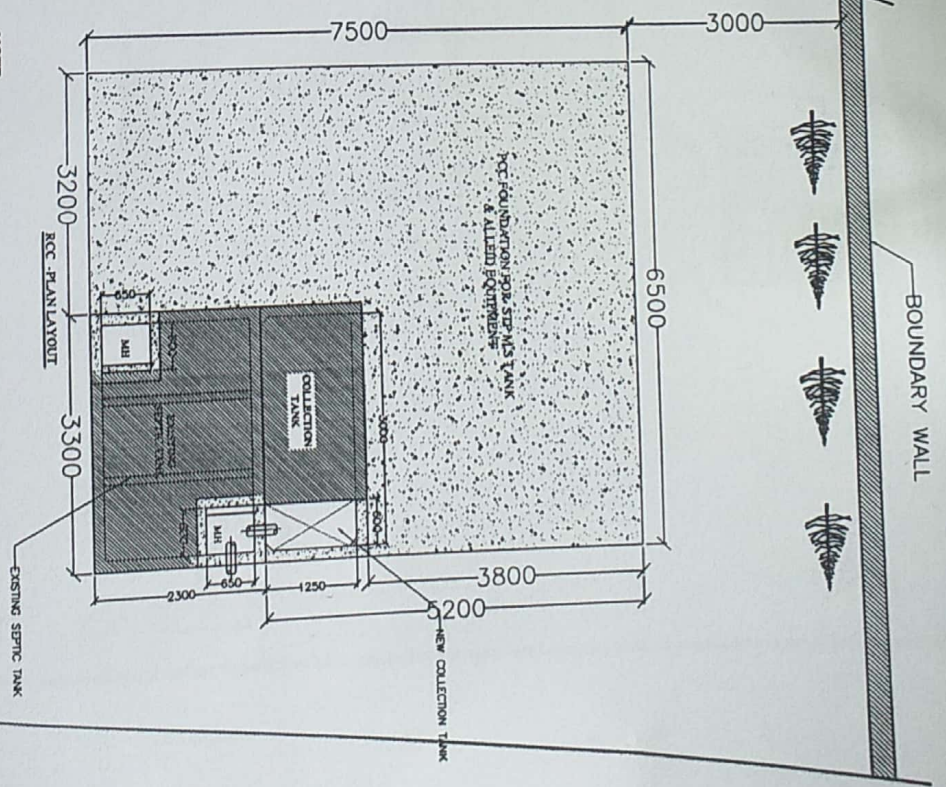

THIS DRAWING IS THE PROPERTY OF SAM CONSULTCH, AMBAD, NASHIK. IT SHOULD NOT BE USED COPIED, REPRODUCED OR EXHIBITED IN ANY DETERIMENTAL TO OUR INTEREST WITHOUT OUR WRITTEN CONSENT

**SAM ENVIRO**  
 PLOT No. F-20, MIDC, AMBAD, NASHIK - 422010  
 CALL : (+91-0283) 2383551, WEB : www.samconengg.com

**CLIENT : METAFORGE ENGINEERING**

**TITLE : PLAN LAYOUT**

DATE : 23.11.20	SCALE : 1:1	DRN : DDS	23.11.20
MATERIAL : RCC		DGN : SSP	23.11.20
DRG. NO. : SAM-JHEETA-05		APPD : SAM	23.11.20
		REVISION :	01